





# Hatherley Mews, Hatherley Lane, Cheltenham, GL51 6HJ

£190,000

🛏 2 🚿 1 🚗 1



- Council Tax Band: B
- Close to local schools
- Up Hatherley location
- Off road parking space
- Family bathroom
- Modern kitchen
- Open plan living area
- First floor
- Two double bedrooms





Set within the popular of Up Hatherley is this well presented two double bedroom first floor apartment in Hatherley Mews.

The accommodation on offer includes an entrance hall, open plan living space including kitchen with additional integrated appliances of oven, hob, extractor fan, fridge/freezer and washing machine. There are two double bedrooms complete with family bathroom. Externally there is an off road parking space and a shared communal garden to the rear of the building.



GROUND FLOOR  
623 sq.ft. (57.9 sq.m.) approx.

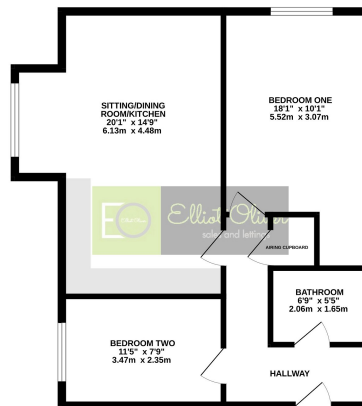

TOTAL FLOOR AREA: 623 sq.ft. (57.9 sq.m.) approx.  
While every effort has been made to ensure the accuracy of the floor plan, the seller does not warrant the accuracy of the floor plan. The floor plan is provided for information only and should not be relied upon for any purpose. The floor plan is not a contract and does not constitute an offer. The floor plan is not a guarantee of any kind and should not be used as such.

